

FASCO[®] OEM Replacement Draft Inducers

Designed, engineered and life-tested in the USA by FASCO.
OEM approved for aftermarket replacement.

- Performance to match the original design.
- Fit for proper operation of the safety pressure switch and condensate management system.
- UL recognized, CSA or cUL certified.
- Safety for your customers and your business.

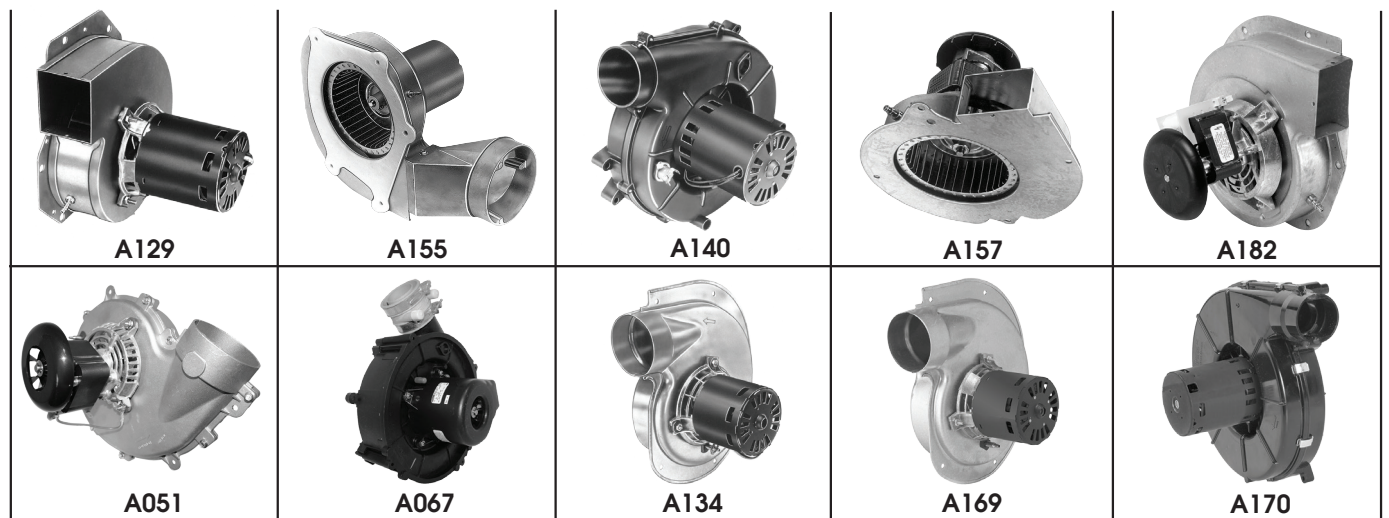

ITEM #	HP	VOLTS	AMPS	TYPE	SPD.	RPM	ROT.	BRNG.	FRAME	OEM CROSS REFERENCE
AMANA										
A129	1/20	115	1.95	SP	1	3250	CW	SLV	3.3	Amana, 7021-9064, 7021-9259
ARMSTRONG										
A155	1/30	115	1.4	SP	1	3000	CCW	BALL	3.3	7021-10046
GOODMAN										
A140	1/50	115	1.4	SP	1	3400	CW	SLV	3.3	7021-9087, 7021-9000
A157	1/35	115	1.3	SP	1	3000	CCW	SLV	-	7002-2307
A182	1/35	115	1.2	SP	1	3125	CCW	SLV	3.3	7002-3036, B4059000
INTERCITY PRODUCTS										
A051	1/60	115	1.6	SP	1	3000	CW	BALL	-	1013833.J238-1393
A067	1/20	115	2.6	SP	1	3000	CW	BALL	3.3	1014338, 119225-00
A134	1/25	115	1.5	SP	1	3060	CW	SLV	3.3	7021-9335, 7021-8735, 7021-9499, 7021-8736
A169	1/25	230	0.75	SP	1	2800	CW	SLV	3.3	7021-10048, 7021-10580
A170	1/25	115	2.3	SP	1	3400	CCW	BALL	3.3	7021-10702, 7021-10299

All rotation is determined by looking at shaft end.

FASCO[®] OEM Replacement Draft Inducers (cont.)

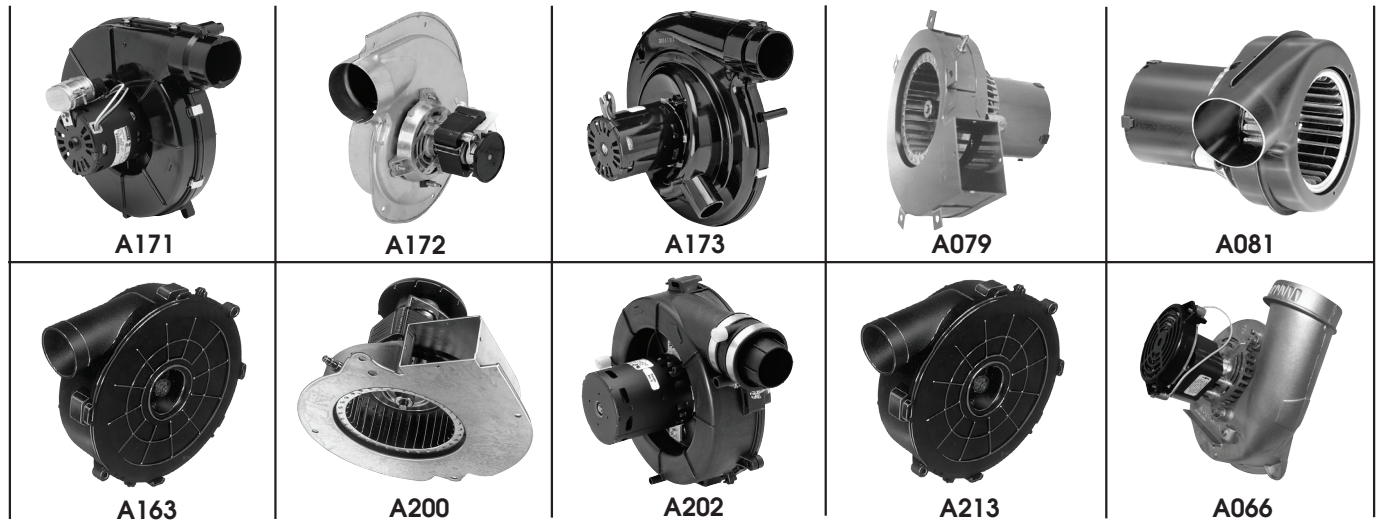

ITEM #	HP	VOLTS	AMPS	TYPE	SPD.	RPM	ROT.	BRNG.	FRAME	OEM CROSS REFERENCE
INTERCITY PRODUCTS										
A171	1/25	115	0.7	PSC	1	3450	CCW	BALL	3.3	7062-4783, 1011412
A172	1/35	115	1.6	SP	1	3000	CW	BALL	-	7002-2792, 1010975P
A173	1/18	115	0.8	PSC	1	3450	CCW	BALL	3.3	7062-4578, 1011350
JANITROL										
A079	1/50	115	1.1	SP	1	3000	CCW	SLV	3.3	7021-6804
JOHNSON FURNACE										
A081¹	1/40	230	0.5	SP	1	3000	CCW	BALL	3.3	HWC Series Unit
LENNOX										
A163	1/20	115	1.8	SP	1	3400	CCW	BALL	3.3	7021-9450
A200	1/30	115	1.95	SP	1	3000	CCW	SLV	-	7002-2975, 31L5501
A202	1/30	115	1.8	SP	1	3400	CCW	BALL	3.3	7021-10602, 45037-001
A213	1/25	115	2.1	SP	2	3200	CCW	BALL	3.3	7021-10376, 18L0401
RHEEM-RUUD										
A066	1/30	120	1.27	SP	1	3000	CW	BALL	3.3	70-24157-03, 117847-00

All rotation is determined by looking at shaft end.
 Note: 1. 3-1/2" motor body length

FASCO[®] OEM Replacement Draft Inducers (cont.)



ITEM #	HP	VOLTS	AMPS	TYPE	SPD.	RPM	ROT.	BRNG.	FRAME	OEM CROSS REFERENCE
TRANE										
A241	1/25	208-230	0.62	SP	1	3200	CW	SLV	3.3	7021-9567, 70-23641-81
A143	1/50	115	0.95	SP	1	3000	CW	SLV	3.3	7021-8428, 7021-8013, 7021-8924
A150	1/35	208-230	0.5	SP	1	3000	CCW	SLV	3.3	7021-7833, 7021-8928
A196	1/25	115	1.35	SP	1	3200	CW	SLV	3.3	7021-11544, D342094P02, 7021-9010, D330757P02
A269	1/35	208-230	0.58/6	SP	1	2500, 3000	CCW	BALL	3.3	7021-11054, X38040363010
A361	1/42	115	1.6	SP	1	3000	CW	BALL	-	7002-2558, D330787P01
YORK										
A137	1/25	115	0.7	PSC	1	3450	CW	SLV	3.3	7062-2442, 7062-3342, 7062-3484
A223	1/30	208-230	0.64	SP	1	3200	CW	SLV	3.3	7021-10096, 026-33999-001, 7021-9656
A225	1/15	115	2.25	SP	1	3200	CW	BALL	3.3	7021-11577, 17503, 7021-11830, 024-34558-000

All rotation is determined by looking at shaft end.

CENTRIFUGAL BLOWERS																	
ITEM #	CFM AT STATIC PRESSURE SHOWN STATIC PRESSURE (INCHES OF WATER)										NAMEPLATE CFM	VOLTS	FREQ.	NO. OF SPEEDS	RPM@ FREE AIR	AMPS@ FREE AIR	BRNG.
	0.1	0.2	0.3	0.4	0.5	0.6	0.7	0.8	0.9	1.0							
A166	110	100	95	85	82	60	40	10	-	-	115	115	50/60	1	3200	1.4	SLV

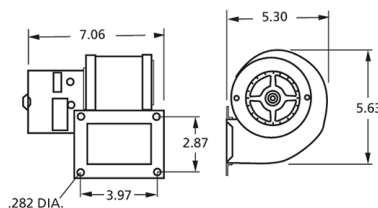

A166 DIMENSIONS



6650 Sugarloaf Parkway
Duluth, GA 30097

678.542.3600

800.995.2222

678.542.3700 fax

www.diversitech.com