

## Powervent PRO Series

**Airflow solutions for residential, commercial & industrial applications.**

- Totally enclosed PSC (Start & Run).
- Suitable working airstream temperatures -40°C (-40°F) to 60°C (140°F).
- Permanently sealed, self lubricating ball bearings.
- Safety thermal overload protection cut-out (automatic reset type).
- Casing manufactured from high grade pressed galvanized steel.
- Extra long inlet and discharge collars for quick and trouble free installation.
- Includes a strong galvanized steel mounting bracket.
- Features a remote mounting, prewired wiring junction box.
- Backward curved centrifugal impeller.

### Powervent PRO Series

Part #	HP	Watts	Volts	Amps	RPM	CFM v Static Pressure (Ps) Ins. WG										Max Ps	Duct Dia.
						0"	0.125"	0.25"	0.375"	0.5"	0.75"	1.0"	1.25"	1.5"			
<b>T9-IB4S</b>	1/15	57	115	0.49	1400	108	100	92	85	78	66	52	33	18	1.70	4"	
<b>T9-IB4</b>	1/9	84	115	0.73	2880	153	142	130	120	111	96	80	63	34	1.85	4"	
<b>T9-IB5</b>	1/9	85	115	0.73	2745	206	190	170	153	135	110	88	62	33	1.77	5"	
<b>T9-IB6</b>	1/5	149	115	1.29	3075	438	420	395	368	335	285	240	203	161	2.29	6"	
<b>T9-IB8</b>	1/4	180	115	1.57	2930	544	515	485	446	415	360	312	273	230	2.64	8"	
<b>T9-IB10</b>	1/3	214	115	1.86	3045	618	595	570	540	510	450	390	340	297	2.80	10"	



Speed shown (RPM) is nominal. Watts are maximum.

Part #	Dimensions (")				Var. Spd. Control	Weight (lbs.)
	A	B	C	D		
<b>T9-IB4/4S</b>	7 5/8	1	9 1/2	3 7/8	92-A8303	6.6
<b>T9-IB5</b>	7 5/8	1	9 1/8	4 7/8	92-A8303	11.1
<b>T9-IB6</b>	8 1/2	1	13 1/8	5 7/8	92-A8303	11.1
<b>T9-IB8</b>	8 1/2	1	13 1/8	7 7/8	92-A8303	11.1
<b>T9-IB10</b>	8 1/8	1	13 1/8	9 7/8	92-A8303	13.2

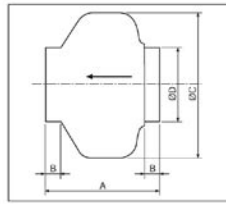

**Powervent Pro Fans Feature**  
4" x 4" Electrical box



## Powervent SILENTLINE Series

**Low Noise, High Airflow, 2 Spd. Solutions for residential, commercial & industrial applications.**

- A superior alternative to the conventional duct fan!
- T9-IB5-2 to T9-IB12-2 utilize a totally enclosed asynchronous (Cap. Start & Run) while T9-IB4-2 is shaded pole.
- Suitable working airstream temperatures -40°C (-40°F) to 60°C (140°F).
- Permanently sealed, self lubricating ball bearings.
- Casing manufactured from a tough heavy gauge pressed steel.
- Extra long inlet and discharge collars for quick and trouble free installation.
- Supplied with "Quick-Fit" mounting bracket.
- Includes a pre-wired junction box.
- Heavy duty mixed flow aluminum impeller.

### Powervent SILENTLINE Series

Part #	HP	Watts	Volts	Amps	Spd.	RPM	CFM v Static Pressure (Ps) Ins. WG										Max Ps	Duct Dia.
							0"	0.125"	0.25"	0.375"	0.5"	0.75"	1.0"	1.25"	1.5"			
<b>T9-IB4-2</b>	1/20	41	115	0.35	Hi	3350	140	123	114	84	59	16	-	-	-	<b>0.83</b>	4"	
		30		0.25	Low	2220	108	83	59	37	9	-	-	-	-	<b>0.57</b>		
<b>T9-IB5-2</b>	1/12	57	115	0.47	Hi	3330	278	257	235	210	177	109	50	-	-	<b>1.27</b>	5"	
		47		0.39	Low	2100	225	193	160	120	87	17	-	-	-	<b>0.86</b>		
<b>T9-IB6-2</b>	1/8	87	115	0.72	Hi	2655	390	367	343	317	283	205	115	-	-	<b>1.24</b>	6"	
		72		0.60	Low	1845	269	225	180	126	91	-	-	-	-	<b>0.72</b>		
<b>T9-IB8-2</b>	1/5	128	115	1.06	Hi	2720	574	545	513	477	431	335	252	175	96	<b>1.86</b>	8"	
		109		0.91	Low	2130	449	405	340	245	201	125	-	-	-	<b>1.00</b>		
<b>T9-IB10-2</b>	1/3	241	115	2.00	Hi	3200	754	715	680	640	606	520	405	310	242	<b>2.53</b>	10"	
		162		1.35	Low	2400	541	475	418	355	295	218	170	130	70	<b>2.03</b>		
<b>T9-IB12-2</b>	1/2	335	115	2.79	Hi	2500	1050	990	932	850	770	600	420	320	258	<b>2.95</b>	12"	
		208		1.73	Low	2000	751	670	545	420	285	190	130	75	25	<b>1.62</b>		



Speed shown (RPM) is maximum. Watts are maximum.

Part #	Dimensions (")				Var. Spd Control	Weight (lbs)
	A	B	C	C		
<b>T9-IB4-2</b>	7 1/2	1	7	3 7/8	92-A8303	5.2
<b>T9-IB5-2</b>	8 1/2	1	8 3/8	4 7/8	92-A8303	5.8
<b>T9-IB6-2</b>	9 1/4	1 1/2	9 1/4	5 7/8	92-A8303	7.2
<b>T9-IB8-2</b>	9 3/8	2	10 1/4	7 7/8	92-A8303	11.2
<b>T9-IB10-2</b>	15 1/8	2	10 3/8	9 7/8	92-A8303	20.7
<b>T9-IB12-2</b>	17 3/4	2	13 1/4	12 1/4	92-A8303	30.8

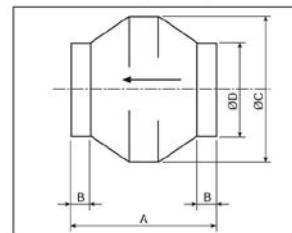

**Powervent Silentline Fans Are**  
Ideal For Indoor or Outdoor Use!



Rotation Determined Opposite Shaft End.  
Double Shaft Determined Lead End.

## COMPACT WALL Axial Fan Series

- Compact Design - Combination of an internal rotor motor and direct drive wrap around impeller hub, requires only a minimal installation depth.
- Installed directly into sidewalls, ceilings or panels to exhaust or supply air to the surrounding environments of residential, commercial and industrial applications.
- Fans feature a unique mounting plate complete with bell mouth inlet and built in finger guard. Also feature a prewired junction box located on the rear of the motor hub for easy access while protecting against the ingress of dust and moisture.



### WALL Fans

- 4 Pole single phase motors.

Part #	HP	Watts	Volts	Amps	RPM	CFM @ Inches WG.										Sones
						0"	0.05"	0.10"	0.15"	0.20"	0.25"	0.30"	0.35"	0.40"	0.50"	
T9-WF12	1/5	132	115	1.1	1500	1260	1200	1130	1040	900	-	-	-	-	-	9.9
T9-WF16	1/2	310	115	2.6	1500	2430	2350	2260	2160	2050	1840	1500	-	-	-	18.9
T9-WF18	3/4	550	115	4.6	1465	3690	3600	3510	3410	3330	3240	3140	3020	2900	2500	19.7
T9-WF20	1	750	115	6.25	1500	4520	4440	4340	4220	4100	3990	3870	3740	3600	3160	28.0

Watts are stated as input. Speed (RPM) shown as nominal.

Part #	Dimensions (")										Var. Spd Control	Weight (lbs.)
	A	B	C	D	E	F	G	H	J			
T9-WF12	15 3/4	12 15/16	11	12 7/16	3/8	12 15/16	2 7/8	5/8	2 1/2	92-A8303	15.0	
T9-WF16	19 11/16	16 5/8	13 15/16	15 3/4	3/8	16 5/8	3 1/16	1 5/8	2 1/2	92-A8303	20.0	
T9-WF18	22 1/16	18 3/4	15 3/4	17 3/4	3/8	18 3/4	3 3/4	1 5/8	2 1/2	92-A8305	29.0	
T9-WF20	24 13/16	21 1/8	17 3/4	19 11/16	3/8	21 1/8	3 7/8	1 3/4	2 1/2	92-A8305	34.0	

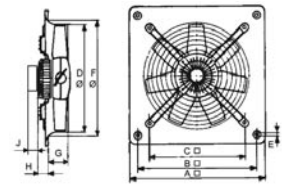

## COMPACT DUCT Axial Fan Series

- Designed to be installed within ducted systems where the fan is supported on both sides.
- Applications include residential, commercial, industrial, agricultural/ greenhouse and OEM.
- Cylindrical flanged casings securely support the compact motor and impeller. All models also feature a prewired junction box located on the cylindrical housing for easy access while protecting against the ingress of dust and moisture.



### DUCT Fans

- 4 Pole single phase motors.

Part #	HP	Watts	Volts	Amps	RPM	CFM @ Inches WG.										Sones
						0	0.05	0.10	0.15	0.20	0.25	0.30	0.35	0.40	0.50	
T9-DF12	1/5	132	115	1.1	1500	1216	1130	940	570	-	-	-	-	-	-	11.6
T9-DF16	1/2	320	115	2.6	1500	2540	2440	2330	2200	2030	1760	-	-	-	-	17.6
T9-DF18	3/4	540	115	4.6	1465	3620	3510	3370	3260	3140	3000	2800	-	-	-	24
T9-DF20	1	770	115	6.4	1500	4750	4630	4500	4380	4240	3090	3930	3660	-	-	32

Watts are stated as input. Speed (RPM) shown as nominal.

Part #	Dimensions (")					Var. Spd Control	Weight (lbs.)
	A	B	C	D	E		
T9-DF12	15 3/16	14	6 11/16	12 7/16	3/8	92-A8303	22
T9-DF16	19 3/16	17 3/4	6 11/16	15 3/4	1/2	92-A8303	31
T9-DF18	21 1/8	19 11/15	1 1/8	17 3/4	1/2	92-A8305	40
T9-DF20	23 7/16	22 1/16	7 1/8	19 11/16	1/2	92-A8305	49

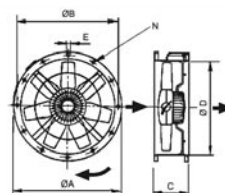

**REFER TO YOUR WHOLESALE FOR ELECTRICAL AND MOUNTING ACCESSORIES**



## Dampers

### Standard Dampers

Part #	Dia.	Width
T9-D4	4"	1.69"
T9-D5	5"	1.93"
T9-D6	6"	2.44"
T9-D8	8"	4.72"
T9-D10	10"	4.72"
T9-D12	12"	6.30"

### Back Draft Standard Dampers

- Back draft shutters are designed to be installed within circular ducting to prevent the back draft of air when a fan is not running.



T9-D8 Illustrated

Rotation Determined Opposite Shaft End.  
Double Shaft Determined Lead End.